

## SURVIVOR® CW-80 Checkweigher Indicator Only



### Approvals



Measurement  
Canada  
Approved



### Standard Features

- Large, bold 0.8" (20.3 mm) Light Emitting Diode (LED) rapid-response display
- Industrial-quality 304 stainless steel construction
- NEMA 4X/IP66 indicator enclosure
- Tough-Touch industrial touch-control front panel with keys for over, under, tare, zero, units, print, target, and ID
- Front-panel "Independent Key Disabling" for: OVER, UNDER, TARE, PRINT, and UNITS keys
- Displays units in decimal lb, kg, oz, lb & oz, grams
- Annunciator lights for unit selection
- High-intensity LED for over, under, and accept
- Storage for up to 300 tare and tolerance settings
- Automatic zero tracking
- 115 VAC or 230 VAC operation
- Bidirectional RS-232 and/or simplex 20 mA current loop communication
- RATTLETRAP® advanced digital filtering
- Combination desk/wall mount bracket
- Power for up to four 350Ω load cells

### Specifications

#### DISPLAY:

Large 0.8" 7-segment, 6-digit high-intensity red Light Emitting Diode (LED) display. Decimal point available at each digit

#### STATUS ANNUNCIATORS:

lb, kg, g, oz, net, motion, center of zero, neg

#### KEYBOARD:

8-key touch control with international symbols

#### BAR GRAPH:

5-segment, 7-range programmable multicolored array tracks Over, Under, Accept status in relation to target value

#### INTERNAL RESOLUTION:

50,000 to 1 million based on filtering selection

#### DISPLAY RESOLUTION:

Selectable up to 50,000 dd

#### MEASUREMENT RATE:

25 updates/second

#### SYSTEM LINEARITY:

0.01% of F.S.

#### ZERO STABILITY:

100 nV/°C maximum

#### SPAN STABILITY:

3 ppm/°C maximum

#### AZM (ZERO TRACK):

Off, ±.5, 1, 2 or 3 dd

#### OPERATIONAL AZM:

±2% or 100% F.S.

#### MOTION BAND:

Off, .5, 1, 2, 3, 5, 10 dd

#### CALIBRATION METHOD:

Software

#### DIGITAL FILTER:

Software selectable 1, 2, 4, 8, 16, 32, 64, 128

#### SENSE AMPLIFIER:

Differential amplifier with 6-wire sensing

#### RFI PROTECTION:

Signal, excitation and sense lines protection.  
3V/m for 100 kHz to 1 GHz,  
≤1 μV susceptibility

#### DIGITAL OUTPUTS:

(Optional) 3 TTL outputs (5 VDC) or 3 N/O relays (10 watts, 0.5 amp, 100 VDC) or 3 N/C relays (10 watts, 0.5 amp, 100 VDC)

#### EDP PORT:

Full duplex, RS-232 or 20 mA simplex output (RS-485 optional)

#### LINE VOLTAGES:

Available in 109-127 or 208-240 VAC models (DC battery backup optional; 24 hrs at 60% duty cycle). Powers 4 x 350Ω load cells

#### FREQUENCY:

50 or 60 Hz

#### OPERATING TEMPERATURE:

14°F to 104°F (-10°C to 40°C)

#### APPROVALS:

NTEP - certified per Handbook 44, Class III/IIIL, 10,000d, CC #96-118; Measurement Canada approved, AM-5146. CUL and UL listed; CE marked

#### WARRANTY:

Two-year limited warranty

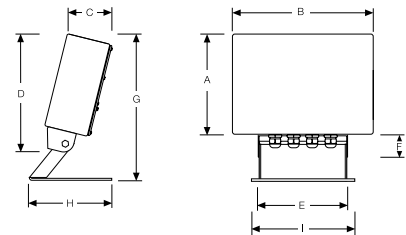

### DIMENSIONS

A = 6.75" (171.5 mm)	F = 1.50" (38.1 mm)
B = 9.50" (241.3 mm)	G = 10.25" (260.4 mm)
C = 3.25" (82.6 mm)	H = 6.50" (165.1 mm)
D = 8.50" (215.9 mm)	I = 4.55" (115.6 mm)
E = 6.00" (152.4 mm)	

# SURVIVOR® CW-80 Indicator

Indicators

PART #	DESCRIPTION	EST. SHIP WEIGHT	PRICE
35974	CW-80 Indicator, 115 VAC	10 lb	\$860.00
35975	CW-80 Indicator, 115 VAC w/TTL outputs	10 lb	965.00
35976	CW-80 Indicator, 115 VAC w/N/O relays	10 lb	1,010.00
35977	CW-80 Indicator, 115 VAC w/N/C relays	10 lb	1,010.00
35981	CW-80 Indicator, 230 VAC	10 lb	860.00
35982	CW-80 Indicator, 230 VAC w/TTL outputs	10 lb	965.00
35983	CW-80 Indicator, 230 VAC w/N/O relays	10 lb	1,010.00
35984	CW-80 Indicator, 230 VAC w/N/C relays	10 lb	1,010.00
<b>Options/Accessories</b>			
32291	Additional operating manual		15.00
<b>Software</b>			
32162	RS-485 communication (factory installed only)		195.00